

INDEX OF SHEETS	
No.	DESCRIPTION
A Sheets	Title Sheets
A.1	Title Sheet
A.2	Location Map Sheet
C Sheets	Quantities and General Information
C.1	Estimated Project Quantities & Reference Information
C.2 - 5	Tabulations & General Notes
J Sheets	Traffic Control and Staging Sheets
J.1	Traffic Control Plan
J.2	511 Travel Restrictions



PLANS OF PROPOSED IMPROVEMENT ON THE
PRIMARY ROAD SYSTEM
O'BRIEN COUNTY
HMA CRACK FILLING
W Jct US 18
to Minnesota State Line

SCALES: As Noted

Refer to the Proposal Form for list of applicable specifications.

Value Engineering Saves. Refer to Article 1105.14 of the Specifications.



DESIGN DATA RURAL			
2026	AADT	1,950	V.P.D.
2046	AADT	—	V.P.D.
2046	DHV	—	V.P.H.
TRUCKS		11	%
Total			
Design ESALs		—	

REVISIONS		TOTAL
		9
PROJECT IDENTIFICATION NUMBER		
26-71-059-020		
PROJECT NUMBER		
MP-059-3(707)194--76-71		
R.O.W. PROJECT NUMBER		

ROADWAY DESIGN	
	<p>I hereby certify that this engineering document was prepared by me or under my direct personal supervision and that I am a duly licensed Professional Engineer under the laws of the State of Iowa.</p> <div><div>Signature</div><div>Justin M. Pottorff</div></div> <div><div>Date</div><div>05/05/2026</div></div> <p>Printed or Typed Name JUSTIN M. POTTORFF</p> <p>My license renewal date is December 31, 2026</p>
Pages or sheets covered by this seal: ALL	

LATITUDE AND LONGITUDE
43°20'39.29"N 95°38'35.45"W

FHWA # 38401

FHWA # 38341

END CONSTRUCTION
MP 215.72

O'Brien/Osceola County Line
MP 199.02

BEGIN CONSTRUCTION
MP 194.03

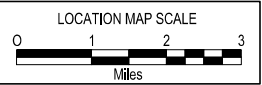
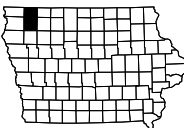
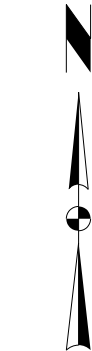
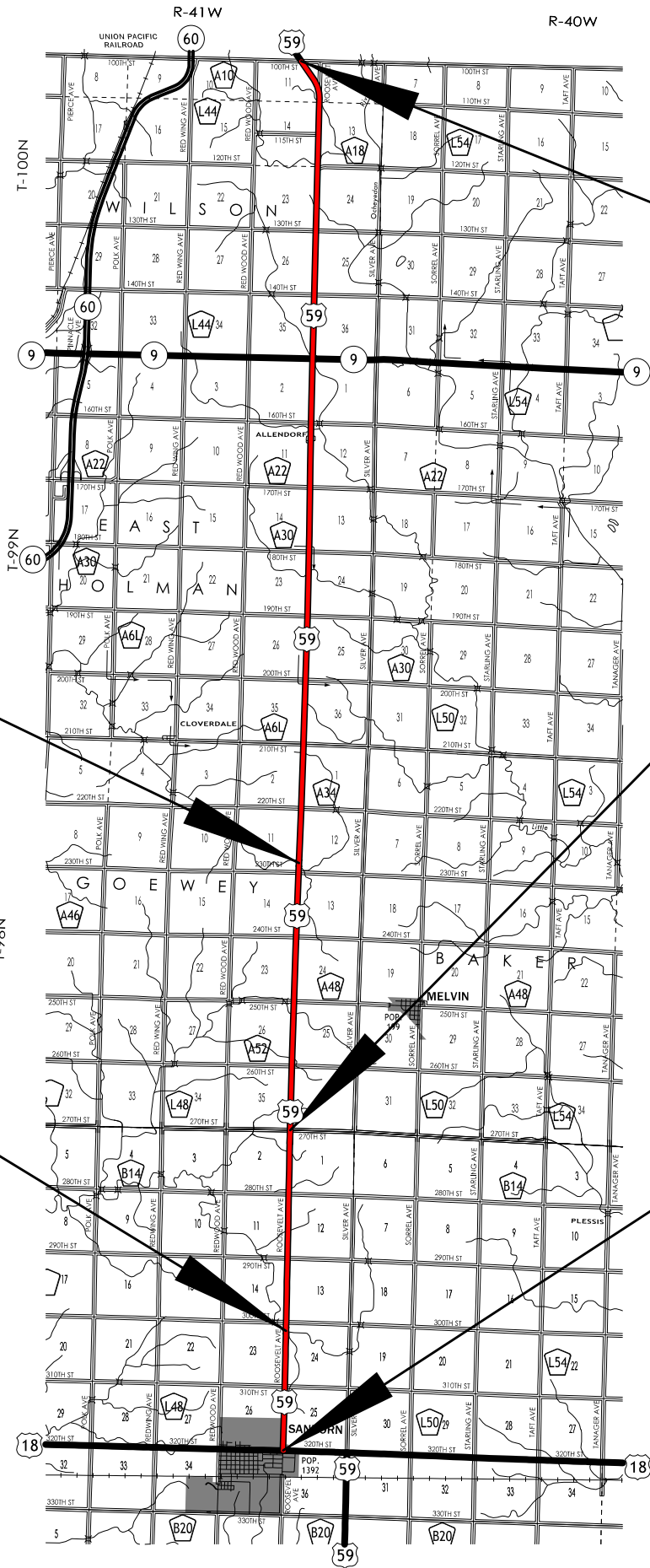

ESTIMATED PROJECT QUANTITIES AND REFERENCE NOTES

Roadway Items : Roadway Items

Item no.	Item Code	Item	Unit	Quantities	Estimate Reference Notes
				Estimated	
				Roadway Items	
1	2528-8445110	TRAFFIC CONTROL	LS	1	Refer to Traffic Control Plan on Tab 108-23A.
2	2528-8445113	FLAGGERS	EACH	0	See Proposal.
3	2528-8445115	PILOT CARS	EACH	0	See Proposal.
4	2533-4980005	MOBILIZATION	LS	1	--
5	2544-1001100	CLEANING AND FILLING CRACKS (PAVEMENT MAINTENANCE)	MILE	21.69	This work shall consist of cleaning and filling cracks in accordance with Std. Spec. 2544.
6	2544-1003000	FILLER MATERIAL (MAINTENANCE)	GAL	13,014	Cracks shall be filled with filler material meeting the requirements of Article 4140, modified for CRS-2P. Quantity estimated at 600 gallons per two lane mile pavement.

<div>PROJECT DESCRIPTION</div> <div>This is a HMA Crack Filling project in O'Brien and Osceola County on US 59 from the West Junction US 18 to the Minnesota State Line.</div>			100_01D 8/15/22					
FILE NO.	ENGLISH	DESIGN TEAM	DISTRICT 3	O' BRIEN COUNTY	PROJECT NUMBER	MP-059-3(707)194--76-71	SHEET NUMBER	C.2

<div>105_04 4/21/26</div> <div>STANDARDS</div> <div>The following Standards apply to construction work on this project.</div>		
Number	Date	Title
TC-1	10-15-19	Work Not Affecting Traffic (Two-Lane or Multi-Lane)
TC-202	04-18-23	Work Within 15 ft of Traveled Way
TC-213	04-18-23	Lane Closure with Flaggers
TC-214	04-18-23	Lane Closure with Flaggers for use with Pilot Car
TC-231	04-18-23	Slow Moving Vehicle Operating in the Traffic Lane

EXISTING PAVEMENT																					102_05 9/29/23
Line No.	County	Route	Direction of Travel	Begin Ref. Location Sign	End Ref. Location Sign	Year	Type	Project Number	Surface Type	Surface Depth (IN)	Base Type	Base Depth (IN)	Subbase Type	Subbase Depth (IN)	Removal Type	Removal Depth (IN)	Coarse Aggregate Source	Coarse Aggregate Type	Course Aggregate Durability Class	Reinforcement Type	Remarks
1.0	O'Brien	US-59	NB	194.01	199.01	2020	M	MP-000-3(735)0--76-00													HMA crack filling
2.0	O'Brien	US-59	NB	194.01	199.01	2001		STPN-59-8(22)--2J-71	AAC	1.5	BAC	1.5					ROSE SPUR QRY	C.LST.			
3.0	O'Brien	US-59	NB	194.01	199.01	1993		MP-59-3(4)194--76-71	BSC												
4.0	O'Brien	US-59	NB	194.01	199.01	1978		FN-59-8(12)--21-71	BAC	1.5	TBB	1.5					ASHTON	GRAVEL			
5.0	O'Brien	US-59	NB	194.01	199.01	1941		FA-769(1)	PC7	7.5							ASHTON	GRAVEL	2		
6.0																					
7.0	Osceola	US-59	NB	199.01	205	2018	M	MP-000-3(730)0--76-00													HMA crack filling
8.0	Osceola	US-59	NB	199.01	205	2001		STPN-59-8(22)--2J-71	AAC	1.5	BAC	1.5					ROSE SPUR QRY	C.LST.			
9.0	Osceola	US-59	NB	199.01	205	1993		MP-59-3(4)194--76-71	BSC												
10.0	Osceola	US-59	NB	199.01	205	1978		FN-59-9(10)--21-72	BAC	1.5	TBB	1.5					KAPPES	GRAVEL			
11.0	Osceola	US-59	NB	199.01	205	1937		FA-734AB	PC7	7.5							WALLINGFORD	GRAVEL	2		OTHER AGG.
13.0	Osceola	US-59	NB	205	215.69	2018	M	MP-000-3(730)0--76-00													HMA crack filling
16.0	Osceola	US-59	NB	205	215.69	1978		FN-59-9(10)--21-72	BAC	1.5	TBB	1.5					KAPPES	GRAVEL			
17.0	Osceola	US-59	NB	205	215.69	1937		FA-734AB	PC7	7.5							WALLINGFORD	GRAVEL	2		OTHER AGG.

262_06
9/28/22

UTILITIES (NOT A POINT 25 PROJECT)

This is NOT a POINT 25 project and is not subject to the provisions of IAC 761-115.25.

<div>TRAFFIC CONTROL PLAN</div> <div><div>1. Through traffic will be maintained on the project at all times.</div><div>2. Traffic control on this project shall be found in accordance with the TC series of Standard Road Plans found in Tabulation 105-4 and/or appropriate Detail Sheets included in the plans. For additional complementary information, refer to part VI of the Manual on Uniform Traffic Control Devices and the current Standard Specifications.</div><div>3. The contractor shall coordinate traffic control with other projects in the area.</div></div>			108_23A 8/15/22					
FILE NO.	ENGLISH	DESIGN TEAM	DISTRICT 3	O' BRIEN COUNTY	PROJECT NUMBER	MP-059-3(707)194--76-71	SHEET NUMBER	J.1

4/30/2026 4:04:10 PM

baeonoaebwarz@dot.iowa.gov

v

108_25
3/28/24

511 TRAVEL RESTRICTIONS													
Line No.	Route	Direction	County	Location Description	Feature Crossed	Object Type	Maint. Bridge No. or Structure ID or FHWA No.	Type of Restriction	Existing Measurement	Construction Measurement	Construction Measurement as Signed	Projected As Built Measurement	Remarks
1.0	US 59	NB	O'Brien	W Jct US 18 to Osceola County Line		Traffic Control Device		Horizontal	N/A	24	N/A	N/A	
2.0	US 59	NB	O'Brien	1.9 mi. N. of N. Jct. 18	Branch Floyd River	Barrier	38341	Horizontal	N/A	44	N/A	N/A	
3.0	US 59	NB	Osceola	O'Brien County Line to Minnesota State Line		Traffic Control Device		Horizontal	N/A	24	N/A	N/A	
4.0	US 59	NB	Osceola	7.8 miles S. of IA 9	Drainage Ditch	Barrier	38401	Horizontal	N/A	44.1	N/A	N/A	