

TRAFFIC CONTROL PLAN

THIS ROAD WILL BE OPEN TO THROUGH TRAFFIC DURING CONSTRUCTION. LOCAL TRAFFIC TO ADJACENT PROPERTIES WILL BE MAINTAINED AS PROVIDED FOR IN ARTICLE 1107.08 OF THE CURRENT STANDARD SPECIFICATIONS. TRAFFIC CONTROL DEVICES WILL BE PLACED AND MAINTAINED BY THE CONTRACTOR.



HIGHWAY DIVISION

PLANS OF PROPOSED IMPROVEMENT ON THE

FARM-TO-MARKET SYSTEM

ADAMS COUNTY

PAVEMENT MARKINGS

ON VARIOUS ROUTES

REFER TO THE PROPOSAL FOR A LIST OF APPLICABLE SPECIFICATIONS

SEE SHEET A.02 FOR PROJECT LOCATIONS

CHRISTOPHER STANDLEY, CHAIR
BOBBI BAKER-MAYNES, VICE-CHAIR
LELAND SHIPLEY
SCOTT AKIN
TONY HARDISTY
DATE APPROVED: 3/16/26
ADAMS COUNTY BOARD OF SUPERVISORS

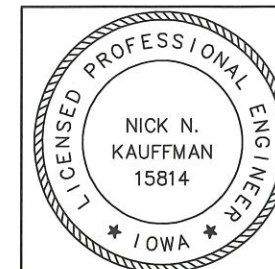

I hereby certify that this engineering document was prepared by me or under my direct personal supervision and that I am a duly licensed Professional Engineer under the laws of the State of Iowa	
	3-16-26
Signature	Date
NICK KAUFFMAN	15814
Printed or Typed Name	License No.
My license renewal date is DECEMBER 31, 2026	
Pages or sheets covered by this seal: A.01-C.07	

INDEX OF SHEETS

No.	Description
A.01	TITLE SHEET, TRAFFIC CONTROL NOTE
A.02	PROJECT LOCATIONS
C.01	ESTIMATED QUANTITES, ESTIMATED REFERENCE
C.01	INFORMATION, STANDARD ROAD PLANS
C.02-C.07	PAVEMENT MARKING TABULATION

SEE SHEET A.02 FOR MILEAGE SUMMARY

SEE SHEET C.01 FOR STANDARD ROAD PLANS

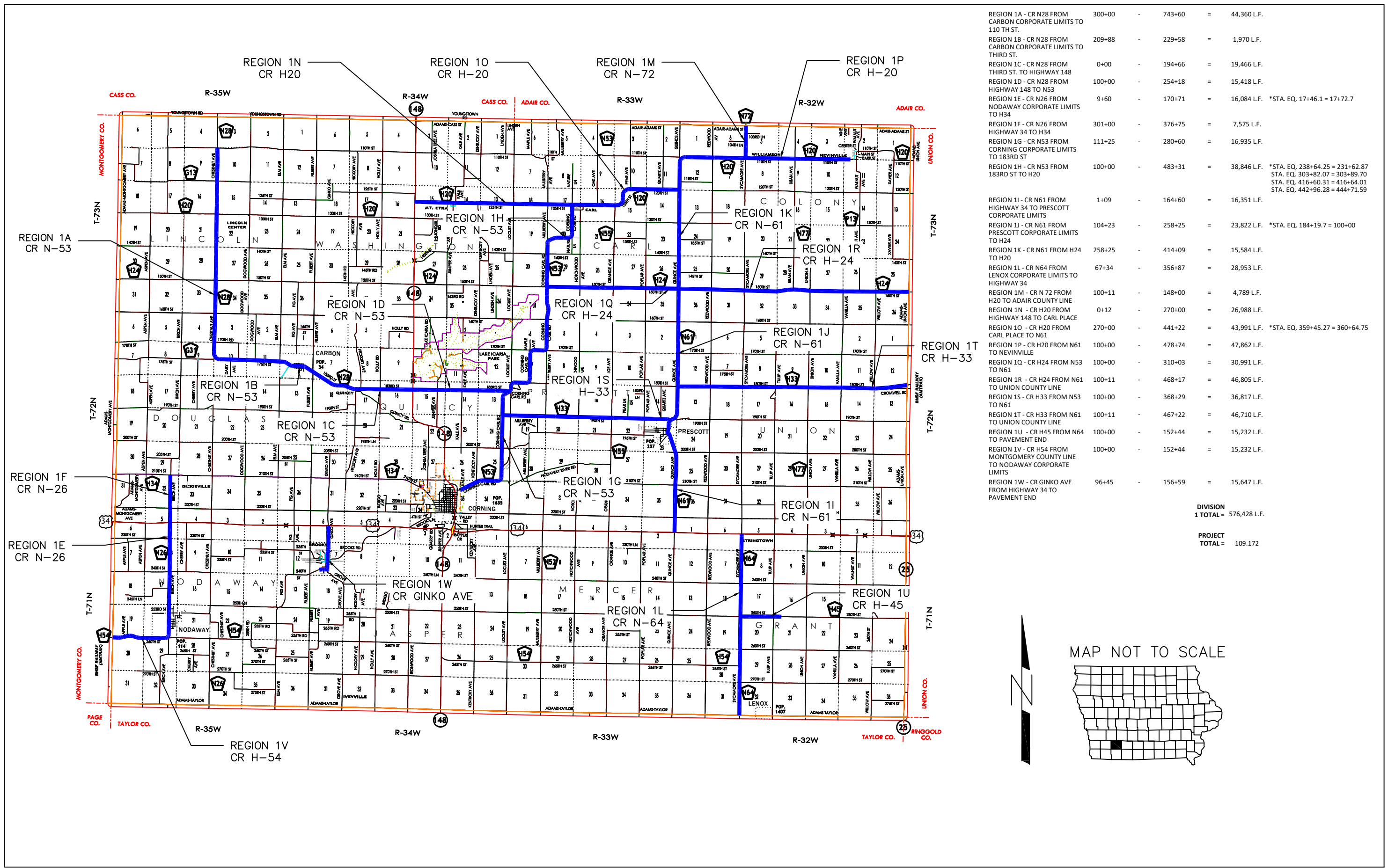

REGION 1A - CR N28 FROM CARBON CORPORATE LIMITS TO 110 TH ST.	300+00	-	743+60	=	44,360 L.F.	
REGION 1B - CR N28 FROM CARBON CORPORATE LIMITS TO THIRD ST.	209+88	-	229+58	=	1,970 L.F.	
REGION 1C - CR N28 FROM THIRD ST. TO HIGHWAY 148	0+00	-	194+66	=	19,466 L.F.	
REGION 1D - CR N28 FROM HIGHWAY 148 TO N53	100+00	-	254+18	=	15,418 L.F.	
REGION 1E - CR N26 FROM NODAWAY CORPORATE LIMITS TO H34	9+60	-	170+71	=	16,084 L.F.	*STA. EQ. 17+46.1 = 17+72.7
REGION 1F - CR N26 FROM HIGHWAY 34 TO H34	301+00	-	376+75	=	7,575 L.F.	
REGION 1G - CR N53 FROM CORNING CORPORATE LIMITS TO 183RD ST	111+25	-	280+60	=	16,935 L.F.	
REGION 1H - CR N53 FROM 183RD ST TO H20	100+00	-	483+31	=	38,846 L.F.	*STA. EQ. 238+64.25 = 231+62.87 STA. EQ. 303+82.07 = 303+89.70 STA. EQ. 416+60.31 = 416+64.01 STA. EQ. 442+96.28 = 444+71.59
REGION 1I - CR N61 FROM HIGHWAY 34 TO PRESCOTT CORPORATE LIMITS	1+09	-	164+60	=	16,351 L.F.	
REGION 1J - CR N61 FROM PRESCOTT CORPORATE LIMITS TO H24	104+23	-	258+25	=	23,822 L.F.	*STA. EQ. 184+19.7 = 100+00
REGION 1K - CR N61 FROM H24 TO H20	258+25	-	414+09	=	15,584 L.F.	
REGION 1L - CR N64 FROM LENOX CORPORATE LIMITS TO HIGHWAY 34	67+34	-	356+87	=	28,953 L.F.	
REGION 1M - CR N 72 FROM H20 TO ADAIR COUNTY LINE	100+11	-	148+00	=	4,789 L.F.	
REGION 1N - CR H20 FROM HIGHWAY 148 TO CARL PLACE	0+12	-	270+00	=	26,988 L.F.	
REGION 1O - CR H20 FROM CARL PLACE TO N61	270+00	-	441+22	=	43,991 L.F.	*STA. EQ. 359+45.27 = 360+64.75
REGION 1P - CR H20 FROM N61 TO NEVINVILLE	100+00	-	478+74	=	47,862 L.F.	
REGION 1Q - CR H24 FROM N53 TO N61	100+00	-	310+03	=	30,991 L.F.	
REGION 1R - CR H24 FROM N61 TO UNION COUNTY LINE	100+11	-	468+17	=	46,805 L.F.	
REGION 1S - CR H33 FROM N53 TO N61	100+00	-	368+29	=	36,817 L.F.	
REGION 1T - CR H33 FROM N61 TO UNION COUNTY LINE	100+11	-	467+22	=	46,710 L.F.	
REGION 1U - CR H45 FROM N64 TO PAVEMENT END	100+00	-	152+44	=	15,232 L.F.	
REGION 1V - CR H54 FROM MONTGOMERY COUNTY LINE TO NODAWAY CORPORATE LIMITS	100+00	-	152+44	=	15,232 L.F.	
REGION 1W - CR GINKO AVE FROM HIGHWAY 34 TO PAVEMENT END	96+45	-	156+59	=	15,647 L.F.	

DIVISION
1 TOTAL = 576,428 L.F.

PROJECT
TOTAL = 109,172



MAP NOT TO SCALE

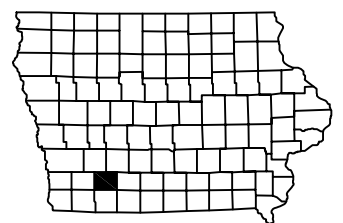

ESTIMATED REFERENCE INFORMATION		
ITEM NO.	ITEM CODE	DESCRIPTION
1	2527-9263209	ITEM INCLUDES ALL MATERIALS, EQUIPMENT, AND LABOR TO APPLY PAVEMENT MARKINGS WITHIN ADAMS COUNTY. QUANTITIES LISTED ARE FOR ESTIMATING PURPOSES ONLY. EXACT QUANTITIES AND LOCATIONS WILL BE DETERMINED IN THE FIELD. SEE SHEET A.02 FOR DETAILS. PRIOR TO APPLYING PAINT, ROADWAY MUST BE SWEEPED TO REMOVE POSSIBLE DEBRIS, SAND, ETC. STATIONS ESTIMATED USING UPDATED IOWA DOT MEASUREMENT FACTORS FOR 4 INCH WIDE LINES (EFFECTIVE APRIL 2024).

ESTIMATED PROJECT QUANTITIES				
ITEM NO.	ITEM CODE	ITEM DESCRIPTION	UNIT	QUANTITIES
1	2527-9263209	PAINTED PAVEMENT MARKINGS, WATERBORNE OR SOLVENT -BASED	STA	10,668.84
2	2528-8445110	TRAFFIC CONTROL	LS	1.00
3	2533-4980005	MOBILIZATION	LS	1.00

STANDARD ROAD PLANS		
THE FOLLOWING STANDARD ROAD PLANS SHALL BE CONSIDERED APPLICABLE TO CONSTRUCTION WORK ON THIS PROJECT		
NUMBER	DATE	TITLE
PM-110	10/15/2024	LINE TYPES
TC-1	10/15/2019	WORK NOT AFFECTING TRAFFIC (TWO-LANE OR MULTI-LANE)
TC-233	10/17/2017	PAVEMENT MARKING OPERATIONS TWO LANE

PAVEMENT MARKING LINE TYPES																											
LINE FACTORS BASED ON 4-INCH WIDE CONTINUOUS LINE				SEE PM-110																							
BCY4: 4" BROKEN CENTERLINE @ 0.17				DCY4: 4" DOUBLE CENTERLINE @ 1.34				NPY4: 4" NO PASSING ZONE @ 0.84				BLW4: 4" BROKEN LANE LINE @ 0.17				ELW4: 4" EDGE LINE @ 0.67											
ELY4: 4" EDGE LINE @ 0.67				SLW2: STOP LINE @ 4.00				DLW4: 4" DOTTED LINE @ 0.22																			
LOCATION																	LENGTH BY LINE TYPE (UNFACTORED)										REMARKS
ROAD ID	STATION TO STATION		DIR. OF TRAVEL	MARKING TYPE	SIDE			BCY4 STA	DCY4 STA	NPY4 STA	BLW4 STA	ELW4 STA	ELY4 STA	SLW2 STA	DLW4 STA												
					L	C	R																				
N28	139+15	178+09	EAST	EDGE LINE (WHITE)	X								38.94				REGION 1D										
N28	178+57	254+18	EAST	EDGE LINE (WHITE)	X								75.61				REGION 1D										
					REGION 1D SUBTOTALS			5.82	59.89	87.97	0.00	306.44	0.00	0.00	0.00												
					QUANTITY FACTORS			0.17	1.34	0.84	0.17	0.67	0.67	4.00	0.22												
					REGION 1D TOTALS			0.99	80.25	73.89	0.00	205.31	0.00	0.00	0.00		TOTAL 360.45 STAT										
N26	9+60	57+30	NORTH	BROKEN CENTERLINE (YELLOW)		X		47.70									REGION 1E										
N26	57+30	67+33	NORTH	NO PASSING ZONE (YELLOW)			X			10.03							REGION 1E										
N26	67+33	70+03	NORTH	DOUBLE CENTERLINE(YELLOW)		X			2.70								REGION 1E										
N26	70+03	78+07	NORTH	NO PASSING ZONE (YELLOW)	X					8.04							REGION 1E										
N26	78+07	78+20	NORTH	DOUBLE CENTERLINE(YELLOW)		X			0.13								REGION 1E										
N26	78+20	89+26	NORTH	NO PASSING ZONE (YELLOW)			X			11.06							REGION 1E										
N26	89+26	97+59	NORTH	DOUBLE CENTERLINE(YELLOW)		X			8.33								REGION 1E										
N26	97+59	108+66	NORTH	NO PASSING ZONE (YELLOW)	X					11.07							REGION 1E										
N26	108+66	108+77	NORTH	DOUBLE CENTERLINE(YELLOW)		X			0.11								REGION 1E										
N26	108+77	115+51	NORTH	NO PASSING ZONE (YELLOW)			X			6.74							REGION 1E										
N26	115+51	118+84	NORTH	BROKEN CENTERLINE (YELLOW)		X		3.33									REGION 1E										
N26	118+84	122+62	NORTH	NO PASSING ZONE (YELLOW)	X					3.78							REGION 1E										
N26	122+62	125+20	NORTH	DOUBLE CENTERLINE(YELLOW)		X			2.58								REGION 1E										
N26	125+20	131+40	NORTH	NO PASSING ZONE (YELLOW)			X			6.20							REGION 1E										
N26	131+40	135+72	NORTH	DOUBLE CENTERLINE(YELLOW)		X			4.32								REGION 1E										
N26	135+72	140+86	NORTH	NO PASSING ZONE (YELLOW)	X					5.14							REGION 1E										
N26	140+86	141+20	NORTH	BROKEN CENTERLINE (YELLOW)		X		0.34									REGION 1E										
N26	141+20	158+27	NORTH	NO PASSING ZONE (YELLOW)			X			17.07							REGION 1E										
N26	9+60	92+56	NORTH	EDGE LINE (WHITE)			X					82.96					REGION 1E										
N26	93+04	170+71		EDGE LINE (WHITE)			X					77.67					REGION 1E										
N26	9+60	66+58		EDGE LINE (WHITE)	X							56.98					REGION 1E										
N26	67+06	92+56		EDGE LINE (WHITE)	X							25.50					REGION 1E										
N26	93+04	145+18		EDGE LINE (WHITE)	X							52.14					REGION 1E										
N26	145+66	170+71		EDGE LINE (WHITE)	X							25.05					REGION 1E										
					REGION 1E SUBTOTALS			51.37	18.17	79.13	0.00	320.30	0.00	0.00	0.00												
					QUANTITY FACTORS			0.17	1.34	0.84	0.17	0.67	0.67	4.00	0.22												
					REGION 1E TOTALS			8.73	24.35	66.47	0.00	214.60	0.00	0.00	0.00		TOTAL 314.15 STAT										
N26	301+12	309+41	NORTH	DOUBLE CENTERLINE(YELLOW)		X		8.29									REGION 1F										
N26	309+41	316+46	NORTH	NO PASSING ZONE (YELLOW)	X					7.05							REGION 1F										
N26	316+46	319+70	NORTH	DOUBLE CENTERLINE(YELLOW)		X			3.24								REGION 1F										
N26	319+70	326+21	NORTH	NO PASSING ZONE (YELLOW)			X			6.51							REGION 1F										
N26	326+21	326+86	NORTH	BROKEN CENTERLINE (YELLOW)		X		0.65									REGION 1F										
N26	326+86	336+01	NORTH	NO PASSING ZONE (YELLOW)	X					9.15							REGION 1F										
N26	336+01	337+33	NORTH	DOUBLE CENTERLINE(YELLOW)		X			1.32								REGION 1F										
N26	337+33	344+81	NORTH	NO PASSING ZONE (YELLOW)			X			7.48							REGION 1F										
N26	344+81	345+77	NORTH	NO PASSING ZONE (YELLOW)	X					0.96							REGION 1F										
N26	345+77	351+45	NORTH	DOUBLE CENTERLINE(YELLOW)		X			5.68								REGION 1F										
N26	351+45	355+33	NORTH	NO PASSING ZONE (YELLOW)			X			3.88							REGION 1F										
N26	355+33	363+22	NORTH	BROKEN CENTERLINE (YELLOW)		X		7.89									REGION 1F										
N26	363+22	376+75	NORTH	NO PASSING ZONE (YELLOW)			X			13.53							REGION 1F										
N26	301+00	323+51	NORTH	EDGE LINE (WHITE)			X					22.51					REGION 1F										
N26	323+99	376+75	NORTH	EDGE LINE (WHITE)			X					52.76					REGION 1F										
N26	301+00	323+51	NORTH	EDGE LINE (WHITE)	X							22.51					REGION 1F										
N26	323+99	376+75	NORTH	EDGE LINE (WHITE)	X							52.76					REGION 1F										
					REGION 1F SUBTOTALS			8.54	18.53	48.56	0.00	150.54	0.00	0.00	0.00												
					QUANTITY FACTORS			0.17	1.34	0.84	0.17	0.67	0.67	4.00	0.22												
					REGION 1F TOTALS			1.45	24.83	40.79	0.00	100.86	0.00	0.00	0.00		TOTAL 167.93 STAT										
N53	111+25	120+60	EAST	DOUBLE CENTERLINE(YELLOW)		X			9.35								REGION 1G										
N53	120+60	124+95	EAST	NO PASSING ZONE (YELLOW)			X			4.35							REGION 1G										
N53	124+95	127+51	EAST	DOUBLE CENTERLINE(YELLOW)			X		2.56								REGION 1G										
N53	127+51	132+73	EAST	NO PASSING ZONE (YELLOW)	X					5.22							REGION 1G										
N53	132+73	136+07	EAST	BROKEN CENTERLINE (YELLOW)		X		3.34									REGION 1G										
N53	136+07	138+86	EAST	NO PASSING ZONE (YELLOW)			X			2.79							REGION 1G										
N53	138+86	139+80	EAST	DOUBLE CENTERLINE(YELLOW)		X			0.94								REGION 1G										
N53	139+80	142+48	EAST	NO PASSING ZONE (YELLOW)			X			2.68							REGION 1G										
N53	142+48	149+34	EAST	DOUBLE CENTERLINE(YELLOW)		X			6.86								REGION 1G										
N53	149+34	157+38	EAST	NO PASSING ZONE (YELLOW)	X					8.04							REGION 1G										
N53	157+38	167+26	EAST	BROKEN CENTERLINE (YELLOW)		X		9.88									REGION 1G										
N53	167+26	174+85	EAST	NO PASSING ZONE (YELLOW)			X			7.59							REGION 1G										
N53	174+85	183+93	EAST	DOUBLE CENTERLINE(YELLOW)		X			9.08								REGION 1G										
N53	183+93	187+05	NORTH	NO PASSING ZONE (YELLOW)	X				3.12								REGION 1G										
N53	187+05	194+12	NORTH	DOUBLE CENTERLINE(YELLOW)		X			7.07								REGION 1G										
N53	194+12	195+50	NORTH	NO PASSING ZONE (YELLOW)			X			1.38							REGION 1G										
N53	195+50	202+13	NORTH	DOUBLE CENTERLINE(YELLOW)		X			6.63								REGION 1G										
N53	202+13	209+43	NORTH	NO PASSING ZONE (YELLOW)	X				7.30								REGION 1G										
N53	209+43	230+51	NORTH	DOUBLE CENTERLINE(YELLOW)		X			21.08								REGION 1G										
N53	230+51	237+63	NORTH	NO PASSING ZONE (YELLOW)	X					7.12							REGION 1G										
N53	237+63	249+72	NORTH	DOUBLE CENTERLINE(YELLOW)		X			12.09								REGION 1G										
N53	249+72	255+28	NORTH	NO PASSING ZONE (YELLOW)	X					5.56							REGION 1G										
N53	255+28	270+55	NORTH	DOUBLE CENTERLINE(YELLOW)		X			15.27								REGION 1G										
N53	270+55	275+88	NORTH	NO PASSING ZONE (YELLOW)	X					5.33							REGION 1G										
N53	275+88	279+79	NORTH	DOUBLE CENTERLINE(YELLOW)		X			3.91								REGION 1G										
N53	279+79	282+52	NORTH	NO PASSING ZONE (YELLOW)			X			2.73							REGION 1G										
N53	282+52	293+87	NORTH	DOUBLE CENTERLINE(YELLOW)		X			11.35								REGION 1G										
N53	293+87	297+62	NORTH	NO PASSING ZONE (YELLOW)	X				3.75								REGION 1G										
N53	297+62	306+77	NORTH	DOUBLE CENTERLINE(YELLOW)		X			9.15								REGION 1G										
N53	111+25	177+81	EAST	EDGE LINE (WHITE)			X					66.56					REGION 1G										

[illegible]

DRAWN BY: CAB	APPROVED BY: NNK	REVISIONS	ADAMS COUNTY HIGHWAY DEPARTMENT	PROJECT FM-C002(84)--55-02	SHT. NAME PAVEMENT MARKINGS – VARIOUS LOCATIONS PROJECT QUANTITIES, NOTES, AND TABULATIONS	SHT. NO. C.03
DATE: 2/24/2026	PROJ. NO.: FM-C002(84)--55-02					
DWG. NO.:	DWG. / /OS (Z:)/Projects/Pavement Markings/ FY 27 Plans/PLANSET - 2026.dwg					

[illegible]

PAVEMENT MARKING LINE TYPES																			
LINE FACTORS BASED ON 4-INCH WIDE CONTINUOUS LINE				SEE PM-110															
BCY4: 4" BROKEN CENTERLINE @ 0.17				DCY4: 4" DOUBLE CENTERLINE @ 1.34				NPY4: 4" NO PASSING ZONE @ 0.84				BLW4: 4" BROKEN LANE LINE @ 0.17				ELW4: 4" EDGE LINE @ 0.67			
ELY4: 4" EDGE LINE @ 0.67				SLW2: STOP LINE @ 4.00				DLW4: 4" DOTTED LINE @ 0.22											
LOCATION																			
ROAD ID	STATION TO STATION	DIR. OF TRAVEL	MARKING TYPE	SIDE			BCY4 STA	DCY4 STA	NPY4 STA	BLW4 STA	ELW4 STA	ELY4 STA	SLW2 STA	DLW4 STA	REMARKS				
				L	C	R													
N61	258+25	308+36	NORTH	EDGE LINE (WHITE)	X						50.11					REGION 1K			
N61	308+84	360+96	NORTH	EDGE LINE (WHITE)	X						52.12					REGION 1K			
N61	361+44	414+09	NORTH	EDGE LINE (WHITE)	X						52.65					REGION 1K			
								REGION 1K SUBTOTALS	28.30	45.48	82.06	0.00	505.44	0.00	0.00				
								QUANTITY FACTORS	0.17	1.34	0.84	0.17	0.67	0.67	4.00	0.22			
								REGION 1K TOTALS	4.81	60.94	68.93	0.00	338.64	0.00	0.00	TOTAL 473.33 STATIONS			
N64	67+34	178+94	NORTH	BROKEN CENTERLINE (YELLOW)		X		111.60								REGION 1L			
N64	178+94	186+20	NORTH	NO PASSING ZONE (YELLOW)			X			7.26						REGION 1L			
N64	186+20	188+79	NORTH	BROKEN CENTERLINE (YELLOW)		X		2.59								REGION 1L			
N64	188+79	197+20	NORTH	NO PASSING ZONE (YELLOW)	X					8.41						REGION 1L			
N64	197+20	215+54	NORTH	BROKEN CENTERLINE (YELLOW)		X		18.34								REGION 1L			
N64	215+54	224+30	NORTH	NO PASSING ZONE (YELLOW)			X			8.76						REGION 1L			
N64	224+30	230+90	NORTH	DOUBLE CENTERLINE (YELLOW)		X		6.60								REGION 1L			
N64	230+90	234+48	NORTH	NO PASSING ZONE (YELLOW)			X			3.58						REGION 1L			
N64	234+48	235+77	NORTH	BROKEN CENTERLINE (YELLOW)		X		1.29								REGION 1L			
N64	235+77	244+63	NORTH	NO PASSING ZONE (YELLOW)	X					8.86						REGION 1L			
N64	244+63	253+38	NORTH	BROKEN CENTERLINE (YELLOW)		X		8.75								REGION 1L			
N64	253+38	262+42	NORTH	NO PASSING ZONE (YELLOW)			X			9.04						REGION 1L			
N64	262+42	266+06	NORTH	DOUBLE CENTERLINE (YELLOW)		X				3.64						REGION 1L			
N64	266+06	275+88	NORTH	NO PASSING ZONE (YELLOW)	X					9.82						REGION 1L			
N64	275+88	350+36	NORTH	BROKEN CENTERLINE (YELLOW)		X		74.48								REGION 1L			
N64	350+36	356+87	NORTH	DOUBLE CENTERLINE (YELLOW)		X				6.51						REGION 1L			
N64	67+34	119+78	NORTH	EDGE LINE (WHITE)			X				52.44					REGION 1L			
N64	120+26	172+57	NORTH	EDGE LINE (WHITE)			X				52.31					REGION 1L			
N64	173+05	225+05	NORTH	EDGE LINE (WHITE)			X				52.00					REGION 1L			
N64	225+53	277+74	NORTH	EDGE LINE (WHITE)			X				52.21					REGION 1L			
N64	278+22	356+87	NORTH	EDGE LINE (WHITE)			X				78.65					REGION 1L			
N64	67+34	146+19	NORTH	EDGE LINE (WHITE)	X						78.85					REGION 1L			
N64	146+67	255+05	NORTH	EDGE LINE (WHITE)	X						108.38					REGION 1L			
N64	225+53	277+74	NORTH	EDGE LINE (WHITE)	X						52.21					REGION 1L			
N64	278+22	356+87	NORTH	EDGE LINE (WHITE)							78.65					REGION 1L			
								REGION 1L SUBTOTALS	217.05	16.75	55.73	0.00	605.70	0.00	0.00				
								QUANTITY FACTORS	0.17	1.34	0.84	0.17	0.67	0.67	4.00	0.22			
								REGION 1L TOTALS	36.90	22.45	46.81	0.00	405.82	0.00	0.00	TOTAL 511.98 STATIONS			
N27	100+12	101+27	NORTH	DOUBLE CENTERLINE (YELLOW)		X				1.15						REGION 1M			
N27	101+27	106+65	NORTH	NO PASSING ZONE (YELLOW)	X						5.38					REGION 1M			
N27	106+65	116+03	NORTH	BROKEN CENTERLINE (YELLOW)		X		9.38								REGION 1M			
N27	116+03	126+32	NORTH	DOUBLE CENTERLINE (YELLOW)		X				10.29						REGION 1M			
N27	126+32	130+78	NORTH	NO PASSING ZONE (YELLOW)	X					4.46						REGION 1M			
N27	130+78	134+79	NORTH	DOUBLE CENTERLINE (YELLOW)		X				4.01						REGION 1M			
N27	134+79	139+26	NORTH	NO PASSING ZONE (YELLOW)			X				4.47					REGION 1M			
N27	139+26	141+86	NORTH	NO PASSING ZONE (YELLOW)	X						2.60					REGION 1M			
N27	141+86	150+55	NORTH	DOUBLE CENTERLINE (YELLOW)		X				8.69						REGION 1M			
N27	150+55	151+05	NORTH	BROKEN CENTERLINE (YELLOW)	X			0.50								REGION 1M			
N27	151+05	151+42	NORTH	NO PASSING ZONE (YELLOW)			X			0.37						REGION 1M			
N27	100+12	139+26	NORTH	EDGE LINE (WHITE)			X				39.14					REGION 1M			
N27	139+74	151+42	NORTH	EDGE LINE (WHITE)			X				11.68					REGION 1M			
N27	100+12	121+06	NORTH	EDGE LINE (WHITE)	X						20.94					REGION 1M			
N27	121+54	151+42	NORTH	EDGE LINE (WHITE)	X						29.88					REGION 1M			
								REGION 1M SUBTOTALS	9.88	24.14	17.28	0.00	101.64	0.00	0.00				
								QUANTITY FACTORS	0.17	1.34	0.84	0.17	0.67	0.67	4.00	0.22			
								REGION 1M TOTALS	1.68	32.35	14.52	0.00	68.10	0.00	0.00	TOTAL 116.64 STATIONS			
H20	0+12	18+13	EAST	DOUBLE CENTERLINE (YELLOW)		X				18.01						REGION 1N			
H20	18+13	27+18	EAST	NO PASSING ZONE (YELLOW)	X						9.05					REGION 1N			
H20	27+18	34+29	EAST	BROKEN CENTERLINE (YELLOW)		X		7.11								REGION 1N			
H20	34+29	42+94	EAST	NO PASSING ZONE (YELLOW)			X				8.65					REGION 1N			
H20	42+94	50+54	EAST	DOUBLE CENTERLINE (YELLOW)		X				7.60						REGION 1N			
H20	50+54	54+17	EAST	NO PASSING ZONE (YELLOW)	X					3.63						REGION 1N			
H20	54+17	122+24	EAST	BROKEN CENTERLINE (YELLOW)		X		68.07								REGION 1N			
H20	122+24	131+06	EAST	NO PASSING ZONE (YELLOW)			X				8.82					REGION 1N			
H20	131+06	137+46	EAST	DOUBLE CENTERLINE (YELLOW)		X				6.40						REGION 1N			
H20	137+46	140+51	EAST	NO PASSING ZONE (YELLOW)	X						3.05					REGION 1N			
H20	140+51	146+80	EAST	BROKEN CENTERLINE (YELLOW)		X		6.29								REGION 1N			
H20	146+80	151+09	EAST	NO PASSING ZONE (YELLOW)			X			4.29						REGION 1N			
H20	151+09	159+04	EAST	DOUBLE CENTERLINE (YELLOW)		X				7.95						REGION 1N			
H20	159+04	167+96	EAST	NO PASSING ZONE (YELLOW)	X						8.92					REGION 1N			
H20	167+96	176+98	EAST	NO PASSING ZONE (YELLOW)			X				9.02					REGION 1N			
H20	176+98	181+57	EAST	DOUBLE CENTERLINE (YELLOW)		X				4.59						REGION 1N			
H20	181+57	186+98	EAST	NO PASSING ZONE (YELLOW)	X						5.41					REGION 1N			
H20	186+98	189+71	EAST	DOUBLE CENTERLINE (YELLOW)		X				2.73						REGION 1N			
H20	189+71	194+24	EAST	NO PASSING ZONE (YELLOW)			X				4.53					REGION 1N			
H20	194+24	203+00	EAST	DOUBLE CENTERLINE (YELLOW)		X				8.76						REGION 1N			
H20	203+00	211+67	EAST	NO PASSING ZONE (YELLOW)	X						8.67					REGION 1N			
H20	211+67	215+64	EAST	BROKEN CENTERLINE (YELLOW)		X				3.97						REGION 1N			
H20	215+64	224+97	EAST	NO PASSING ZONE (YELLOW)			X				9.33					REGION 1N			
H20	224+97	228+41	EAST	DOUBLE CENTERLINE (YELLOW)		X				3.44						REGION 1N			
H20	228+41	237+83	EAST	NO PASSING ZONE (YELLOW)	X						9.42					REGION 1N			
H20	237+83	238+34	EAST	BROKEN CENTERLINE (YELLOW)		X		0.51								REGION 1N			
H20	238+34	244+52	EAST	NO PASSING ZONE (YELLOW)			X				6.18					REGION 1N			
H20	244+52	252+00	EAST	DOUBLE CENTERLINE (YELLOW)		X				7.48						REGION 1N			
H20	252+00	253+68	EAST	DOUBLE CENTERLINE (YELLOW)		X				1.68						REGION 1N			
H20	261+16	260+84	EAST	NO PASSING ZONE (YELLOW)	X					0.32						REGION 1N			

DRAWN BY: CAB	APPROVED BY: NNN	REVISIONS	ADAMS COUNTY HIGHWAY DEPARTMENT	PROJECT	FM-C002(84)--55-02	SHT. NAME	SHT. NO.
DATE: 2/24/2026	PROJ. NO.: FM-C002(84)--55-02					PAVEMENT MARKINGS – VARIOUS LOCATIONS	C.04
DWG. NO.:	DWG.: //OS (Z:)/Projects/Pavement Markings/ FY 27 Plans/PLANSET – 2026.dwg					PROJECT QUANTITIES, NOTES, AND TABULATIONS	

PAVEMENT MARKING LINE TYPES																							
LINE FACTORS BASED ON 4-INCH WIDE CONTINUOUS LINE				SEE PM-110																			
BCY4: 4" BROKEN CENTERLINE @ 0.17				DCY4: 4" DOUBLE CENTERLINE @ 1.34				NPY4: 4" NO PASSING ZONE @ 0.84				BLW4: 4" BROKEN LANE LINE @ 0.17				ELW4: 4" EDGE LINE @ 0.67							
ELY4: 4" EDGE LINE @ 0.67				SLW2: STOP LINE @ 4.00				DLW4: 4" DOTTED LINE @ 0.22															
LOCATION				LENGTH BY LINE TYPE (UNFACTORED)												REMARKS							
ROAD ID	STATION TO STATION	DIR. OF TRAVEL	MARKING TYPE	SIDE			BCY4 STA	DCY4 STA	NPY4 STA	BLW4 STA	ELW4 STA	ELY4 STA	SLW2 STA	DLW4 STA									
				L	C	R																	
H20	268+32	270+00	EAST	DOUBLE CENTERLINE(YELLOW)		X			1.68							REGION 1N							
H20	0+12	54+51	EAST	EDGE LINE (WHITE)			X				54.39					REGION 1N							
H20	54+99	60+86	EAST	EDGE LINE (WHITE)			X				5.87					REGION 1N							
H20	61+34	64+91	EAST	EDGE LINE (WHITE)			X				3.57					REGION 1N							
H20	65+39	100+71	EAST	EDGE LINE (WHITE)			X				35.32					REGION 1N							
H20	101+19	157+56	EAST	EDGE LINE (WHITE)			X				56.37					REGION 1N							
H20	158+04	212+36	EAST	EDGE LINE (WHITE)			X				54.32					REGION 1N							
H20	212+84	252+00	EAST	EDGE LINE (WHITE)			X				39.16					REGION 1N							
H20	252+00	270+00	EAST	EDGE LINE (WHITE)			X				18.00					REGION 1N							
H20	0+12	64+91	EAST	EDGE LINE (WHITE)	X						64.79					REGION 1N							
H20	65+39	212+36	EAST	EDGE LINE (WHITE)	X						146.97					REGION 1N							
H20	212+84	252+00	EAST	EDGE LINE (WHITE)	X						39.16					REGION 1N							
H20	252+00	270+00	EAST	EDGE LINE (WHITE)	X						18.00					REGION 1N							
				REGION 1N SUBTOTALS				85.95	70.32	99.29	0.00	535.92	0.00	0.00	0.00								
				QUANTITY FACTORS				0.17	1.34	0.84	0.17	0.67	0.67	4.00	0.22								
				REGION 1N TOTALS				14.61	94.23	83.40	0.00	359.07	0.00	0.00	0.00	TOTAL 551.31 STATIONS							
H20	270+00	270+42	EAST	DOUBLE CENTERLINE(YELLOW)		X			0.42							REGION 1O							
H20	270+42	276+76	EAST	NO PASSING ZONE (YELLOW)			X			6.34						REGION 1O							
H20	276+76	279+76	EAST	DOUBLE CENTERLINE(YELLOW)		X			3.00							REGION 1O							
H20	279+76	285+48	EAST	NO PASSING ZONE (YELLOW)	X					5.72						REGION 1O							
H20	285+48	288+85	EAST	DOUBLE CENTERLINE(YELLOW)		X			3.37							REGION 1O							
H20	288+85	295+28	EAST	NO PASSING ZONE (YELLOW)			X			6.43						REGION 1O							
H20	295+28	300+44	EAST	NO PASSING ZONE (YELLOW)	X					5.16						REGION 1O							
H20	300+44	303+32	EAST	DOUBLE CENTERLINE(YELLOW)		X			2.88							REGION 1O							
H20	303+32	308+34	EAST	NO PASSING ZONE (YELLOW)			X			5.02						REGION 1O							
H20	308+34	310+55	EAST	DOUBLE CENTERLINE(YELLOW)		X			2.21							REGION 1O							
H20	310+55	316+70	EAST	NO PASSING ZONE (YELLOW)	X					6.15						REGION 1O							
H20	316+70	319+07	EAST	DOUBLE CENTERLINE(YELLOW)		X			2.37							REGION 1O							
H20	319+07	326+54	EAST	NO PASSING ZONE (YELLOW)			X			7.47						REGION 1O							
H20	326+54	356+61	EAST	DOUBLE CENTERLINE(YELLOW)		X			30.07							REGION 1O							
H20	356+61	363+63	EAST	NO PASSING ZONE (YELLOW)	X					5.83						REGION 1O							
H20	363+63	368+01	EAST	DOUBLE CENTERLINE(YELLOW)		X			4.38							REGION 1O							
H20	368+01	373+08	EAST	NO PASSING ZONE (YELLOW)			X			5.07						REGION 1O							
H20	373+08	381+32	EAST	NO PASSING ZONE (YELLOW)	X					8.24						REGION 1O							
H20	381+32	387+44	EAST	BROKEN CENTERLINE (YELLOW)		X		6.12								REGION 1O							
H20	387+44	396+11	EAST	NO PASSING ZONE (YELLOW)			X			8.67						REGION 1O							
H20	396+11	400+41	EAST	DOUBLE CENTERLINE(YELLOW)		X			4.30							REGION 1O							
H20	400+41	407+49	EAST	NO PASSING ZONE (YELLOW)	X					7.08						REGION 1O							
H20	407+49	408+74	EAST	DOUBLE CENTERLINE(YELLOW)		X			1.25							REGION 1O							
H20	408+74	416+54	EAST	NO PASSING ZONE (YELLOW)			X			7.80						REGION 1O							
H20	416+54	421+94	EAST	DOUBLE CENTERLINE(YELLOW)		X			5.40							REGION 1O							
H20	421+94	429+22	EAST	NO PASSING ZONE (YELLOW)	X					7.28						REGION 1O							
H20	429+22	429+96	EAST	DOUBLE CENTERLINE(YELLOW)		X			0.74							REGION 1O							
H20	429+96	436+86	EAST	NO PASSING ZONE (YELLOW)			X			6.90						REGION 1O							
H20	436+86	441+21	EAST	DOUBLE CENTERLINE(YELLOW)		X			4.35							REGION 1O							
H20	270+00	319+24	EAST	EDGE LINE (WHITE)			X				49.24					REGION 1O							
H20	319+72	441+21	EAST	EDGE LINE (WHITE)			X				120.30					REGION 1O							
H20	270+00	291+60	EAST	EDGE LINE (WHITE)	X						21.60					REGION 1O							
H20	292+08	363+39	EAST	EDGE LINE (WHITE)	X						70.12					REGION 1O							
H20	363+87	414+59	EAST	EDGE LINE (WHITE)	X						50.72					REGION 1O							
H20	415+07	441+21	EAST	EDGE LINE (WHITE)	X						26.14					REGION 1O							
				REGION 1O SUBTOTALS				6.12	64.74	99.16	0.00	338.12	0.00	0.00	0.00								
				QUANTITY FACTORS				0.17	1.34	0.84	0.17	0.67	0.67	4.00	0.22								
				REGION 1O TOTALS				1.04	86.75	83.29	0.00	226.54	0.00	0.00	0.00	TOTAL 397.63 STATIONS							
H20	100+00	109+73	NORTH	DOUBLE CENTERLINE(YELLOW)		X			9.73							REGION 1P							
H20	109+73	113+35	NORTH	NO PASSING ZONE (YELLOW)	X					3.62						REGION 1P							
H20	113+35	119+10	NORTH	NO PASSING ZONE (YELLOW)			X			5.75						REGION 1P							
H20	119+10	119+88	NORTH	BROKEN CENTERLINE (YELLOW)		X		0.78								REGION 1P							
H20	119+88	126+28	NORTH	NO PASSING ZONE (YELLOW)	X					6.40						REGION 1P							
H20	126+28	137+71	NORTH	BROKEN CENTERLINE (YELLOW)		X		11.43								REGION 1P							
H20	137+71	153+08	NORTH	NO PASSING ZONE (YELLOW)			X			15.37						REGION 1P							
H20	153+08	158+11	EAST	DOUBLE CENTERLINE(YELLOW)		X			5.03							REGION 1P							
H20	158+11	162+25	EAST	NO PASSING ZONE (YELLOW)	X					4.14						REGION 1P							
H20	162+25	166+58	EAST	DOUBLE CENTERLINE(YELLOW)		X			4.33							REGION 1P							
H20	166+58	171+81	EAST	NO PASSING ZONE (YELLOW)			X			5.23						REGION 1P							
H20	171+81	173+48	EAST	DOUBLE CENTERLINE(YELLOW)		X			1.67							REGION 1P							
H20	173+48	179+05	EAST	NO PASSING ZONE (YELLOW)	X					5.57						REGION 1P							
H20	179+05	182+01	EAST	DOUBLE CENTERLINE(YELLOW)		X			2.96							REGION 1P							
H20	182+01	186+90	EAST	NO PASSING ZONE (YELLOW)			X			4.89						REGION 1P							
H20	186+90	198+26	EAST	DOUBLE CENTERLINE(YELLOW)		X			11.36							REGION 1P							
H20	198+26	206+77	EAST	NO PASSING ZONE (YELLOW)	X					8.51						REGION 1P							
H20	206+77	210+49	EAST	BROKEN CENTERLINE (YELLOW)		X		3.72								REGION 1P							
H20	210+49	219+46	EAST	NO PASSING ZONE (YELLOW)			X			8.97						REGION 1P							
H20	219+46	231+26	EAST	DOUBLE CENTERLINE(YELLOW)		X			11.80							REGION 1P							
H20	231+26	237+61	EAST	NO PASSING ZONE (YELLOW)	X					6.35						REGION 1P							
H20	237+61	240+32	EAST	DOUBLE CENTERLINE(YELLOW)		X			2.71							REGION 1P							
H20	240+32	245+20	EAST	NO PASSING ZONE (YELLOW)			X			4.88						REGION 1P							
H20	245+20	260+82	EAST	DOUBLE CENTERLINE(YELLOW)		X			15.62							REGION 1P							
H20	260+82	269+47	EAST	NO PASSING ZONE (YELLOW)			X			8.65						REGION 1P							
H20	269+47	274+57	EAST	DOUBLE CENTERLINE(YELLOW)		X			5.10							REGION 1P							
H20	274+57	283+87	EAST	NO PASSING ZONE (YELLOW)	X					9.30						REGION 1P							
H20	283+87	286+51	EAST	BROKEN CENTERLINE (YELLOW)		X		2.64								REGION 1P							
H20	286+51	295+35	EAST	NO PASSING ZONE (YELLOW)			X			8.84						REGION 1P							
H20	295+35	301+54	EAST	DOUBLE CENTERLINE(YELLOW)		X			6.19							REGION 1P							

PAVEMENT MARKING LINE TYPES																			
LINE FACTORS BASED ON 4-INCH WIDE CONTINUOUS LINE				SEE PM-110															
BCY4: 4" BROKEN CENTERLINE @ 0.17				DCY4: 4" DOUBLE CENTERLINE @ 1.34				NPY4: 4" NO PASSING ZONE @ 0.84				BLW4: 4" BROKEN LANE LINE @ 0.17				ELW4: 4" EDGE LINE @ 0.67			
ELY4: 4" EDGE LINE @ 0.67				SLW2: STOP LINE @ 4.00				DLW4: 4" DOTTED LINE @ 0.22											
LOCATION																			
ROAD ID	STATION TO STATION		DIR. OF TRAVEL	MARKING TYPE	SIDE			BCY4 STA	DCY4 STA	NPY4 STA	BLW4 STA	ELW4 STA	ELY4 STA	SLW2 STA	DLW4 STA	REMARKS			
					L	C	R												
H20	301+54	306+62	EAST	NO PASSING ZONE (YELLOW)	X					5.08						REGION 1P			
H20	306+62	310+67	EAST	DOUBLE CENTERLINE(YELLOW)		X			4.05							REGION 1P			
H20	310+67	314+69	EAST	NO PASSING ZONE (YELLOW)			X			4.02						REGION 1P			
H20	314+69	315+83	EAST	DOUBLE CENTERLINE(YELLOW)		X			1.14							REGION 1P			
H20	315+83	324+88	EAST	NO PASSING ZONE (YELLOW)	X					9.05						REGION 1P			
H20	324+88	332+64	EAST	NO PASSING ZONE (YELLOW)			X			7.76						REGION 1P			
H20	332+64	335+91	EAST	BROKEN CENTERLINE (YELLOW)		X		3.27								REGION 1P			
H20	335+91	338+90	EAST	NO PASSING ZONE (YELLOW)	X					2.99						REGION 1P			
H20	338+90	343+96	EAST	DOUBLE CENTERLINE(YELLOW)		X			5.06							REGION 1P			
H20	343+96	349+01	EAST	NO PASSING ZONE (YELLOW)			X			5.05						REGION 1P			
H20	349+01	354+75	EAST	NO PASSING ZONE (YELLOW)			X			5.74						REGION 1P			
H20	354+75	358+34	EAST	DOUBLE CENTERLINE(YELLOW)		X			3.59							REGION 1P			
H20	358+34	391+39	EAST	BROKEN CENTERLINE (YELLOW)		X		33.05								REGION 1P			
H20	391+39	395+12	EAST	NO PASSING ZONE (YELLOW)	X					3.73						REGION 1P			
H20	395+12	418+74	EAST	BROKEN CENTERLINE (YELLOW)		X		23.62								REGION 1P			
H20	100+00	113+88	NORTH	EDGE LINE (WHITE)			X				13.88					REGION 1P			
H20	114+36	201+26	NORTH	EDGE LINE (WHITE)			X				86.90					REGION 1P			
H20	201+74	254+01	EAST	EDGE LINE (WHITE)			X				52.27					REGION 1P			
H20	254+49	329+86	EAST	EDGE LINE (WHITE)			X				75.37					REGION 1P			
H20	330+34	418+74	EAST	EDGE LINE (WHITE)			X				88.40					REGION 1P			
H20	100+00	150+76	NORTH	EDGE LINE (WHITE)	X						50.76					REGION 1P			
H20	151+24	201+26	EAST	EDGE LINE (WHITE)	X						50.02					REGION 1P			
H20	201+74	254+01	EAST	EDGE LINE (WHITE)	X						52.27					REGION 1P			
H20	254+49	329+86	EAST	EDGE LINE (WHITE)	X						75.37					REGION 1P			
H20	330+34	359+26	EAST	EDGE LINE (WHITE)	X						28.92					REGION 1P			
H20	359+74	418+74	EAST	EDGE LINE (WHITE)	X						59.00					REGION 1P			
								REGION 1P SUBTOTALS	78.51	90.34	149.89	0.00	633.16	0.00	0.00	0.00			
								QUANTITY FACTORS	0.17	1.34	0.84	0.17	0.67	0.67	4.00	0.22			
								REGION 1P TOTALS	13.35	121.06	125.91	0.00	424.22	0.00	0.00	0.00	TOTAL 684.53 STATIONS		
H24	100+12	106+54	EAST	NO PASSING ZONE (YELLOW)	X					6.42						REGION 1Q			
H24	106+54	119+14	EAST	BROKEN CENTERLINE (YELLOW)		X		12.60								REGION 1Q			
H24	119+14	129+51	EAST	NO PASSING ZONE (YELLOW)			X			10.37						REGION 1Q			
H24	129+51	131+50	EAST	DOUBLE CENTERLINE(YELLOW)		X			1.99							REGION 1Q			
H24	131+50	141+65	EAST	NO PASSING ZONE (YELLOW)	X					10.15						REGION 1Q			
H24	141+65	151+22	EAST	NO PASSING ZONE (YELLOW)			X			9.57						REGION 1Q			
H24	151+22	153+99	EAST	DOUBLE CENTERLINE(YELLOW)		X			2.77							REGION 1Q			
H24	153+99	164+25	EAST	NO PASSING ZONE (YELLOW)	X					10.26						REGION 1Q			
H24	164+25	170+12	EAST	BROKEN CENTERLINE (YELLOW)		X		5.87								REGION 1Q			
H24	170+12	179+42	EAST	NO PASSING ZONE (YELLOW)			X			9.30						REGION 1Q			
H24	179+42	188+73	EAST	DOUBLE CENTERLINE(YELLOW)		X			9.31							REGION 1Q			
H24	188+73	195+38	EAST	NO PASSING ZONE (YELLOW)	X					6.65						REGION 1Q			
H24	195+38	196+95	EAST	DOUBLE CENTERLINE(YELLOW)		X			1.57							REGION 1Q			
H24	196+95	204+16	EAST	NO PASSING ZONE (YELLOW)			X			7.21						REGION 1Q			
H24	204+16	208+74	EAST	DOUBLE CENTERLINE(YELLOW)					4.58							REGION 1Q			
H24	208+74	214+55	EAST	NO PASSING ZONE (YELLOW)	X					5.81						REGION 1Q			
H24	214+55	217+91	EAST	DOUBLE CENTERLINE(YELLOW)		X			3.36							REGION 1Q			
H24	217+91	226+69	EAST	NO PASSING ZONE (YELLOW)			X			8.78						REGION 1Q			
H24	226+69	230+49	EAST	DOUBLE CENTERLINE(YELLOW)		X			3.80							REGION 1Q			
H24	230+49	239+54	EAST	NO PASSING ZONE (YELLOW)	X					9.05						REGION 1Q			
H24	239+54	247+47	EAST	BROKEN CENTERLINE (YELLOW)		X		7.93								REGION 1Q			
H24	247+47	255+74	EAST	NO PASSING ZONE (YELLOW)			X			8.27						REGION 1Q			
H24	255+74	270+19	EAST	DOUBLE CENTERLINE(YELLOW)		X			14.45							REGION 1Q			
H24	270+19	279+15	EAST	NO PASSING ZONE (YELLOW)	X					8.96						REGION 1Q			
H24	279+15	285+59	EAST	BROKEN CENTERLINE (YELLOW)		X		6.44								REGION 1Q			
H24	285+59	295+53	EAST	NO PASSING ZONE (YELLOW)			X			9.94						REGION 1Q			
H24	295+53	300+87	EAST	DOUBLE CENTERLINE(YELLOW)		X			5.34							REGION 1Q			
H24	300+87	306+00	EAST	NO PASSING ZONE (YELLOW)	X					5.13						REGION 1Q			
H24	306+00	309+91	EAST	DOUBLE CENTERLINE(YELLOW)		X			3.91							REGION 1Q			
H24	100+12	152+26	EAST	EDGE LINE (WHITE)			X				52.14					REGION 1Q			
H24	152+74	205+51	EAST	EDGE LINE (WHITE)			X				52.77					REGION 1Q			
H24	205+99	270+56	EAST	EDGE LINE (WHITE)			X				64.57					REGION 1Q			
H24	271+04	309+91	EAST	EDGE LINE (WHITE)			X				38.87					REGION 1Q			
H24	100+12	152+26	EAST	EDGE LINE (WHITE)	X						52.14					REGION 1Q			
H24	152+74	205+51	EAST	EDGE LINE (WHITE)	X						52.77					REGION 1Q			
H24	205+99	270+56	EAST	EDGE LINE (WHITE)	X						64.57					REGION 1Q			
H24	271+04	309+91	EAST	EDGE LINE (WHITE)	X						38.87					REGION 1Q			
								REGION 1Q SUBTOTALS	32.84	51.08	125.87	0.00	416.70	0.00	0.00	0.00			
								QUANTITY FACTORS	0.17	1.34	0.84	0.17	0.67	0.67	4.00	0.22			
								REGION 1Q TOTALS	5.58	68.45	105.73	0.00	279.19	0.00	0.00	0.00	TOTAL 458.95 STATIONS		
H24	100+11	109+53	EAST	DOUBLE CENTERLINE(YELLOW)		X			9.42							REGION 1R			
H24	109+53	118+15	EAST	NO PASSING ZONE (YELLOW)	X				8.62							REGION 1R			
H24	118+15	124+07	EAST	NO PASSING ZONE (YELLOW)			X		5.92							REGION 1R			
H24	124+07	125+15	EAST	BROKEN CENTERLINE (YELLOW)		X		1.08								REGION 1R			
H24	125+15	133+41	EAST	NO PASSING ZONE (YELLOW)	X					8.26						REGION 1R			
H24	133+41	138+12	EAST	BROKEN CENTERLINE (YELLOW)		X		4.71								REGION 1R			
H24	138+12	147+69	EAST	NO PASSING ZONE (YELLOW)			X			9.57						REGION 1R			
H24	147+69	155+31	EAST	DOUBLE CENTERLINE(YELLOW)		X			7.62							REGION 1R			
H24	155+31	157+90	EAST	NO PASSING ZONE (YELLOW)	X					2.59						REGION 1R			
H24	157+90	161+55	EAST	DOUBLE CENTERLINE(YELLOW)		X			3.65							REGION 1R			
H24	161+55	166+62	EAST	NO PASSING ZONE (YELLOW)			X			5.07						REGION 1R			
H24	166+62	183+24	EAST	DOUBLE CENTERLINE(YELLOW)		X			16.62							REGION 1R			
H24	183+24	191+42	EAST	NO PASSING ZONE (YELLOW)	X					8.18						REGION 1R			
H24	191+42	193+70	EAST	BROKEN CENTERLINE (YELLOW)		X		2.28								REGION 1R			
H24	193+70	202+88	EAST	NO PASSING ZONE (YELLOW)			X			9.18						REGION 1R			

PAVEMENT MARKING LINE TYPES																						
LINE FACTORS BASED ON 4-INCH WIDE CONTINUOUS LINE				SEE PM-110																		
BCY4: 4" BROKEN CENTERLINE @ 0.17				DCY4: 4" DOUBLE CENTERLINE @ 1.34				NPY4: 4" NO PASSING ZONE @ 0.84				BLW4: 4" BROKEN LANE LINE @ 0.17				ELW4: 4" EDGE LINE @ 0.67						
ELY4: 4" EDGE LINE @ 0.67				SLW2: STOP LINE @ 4.00				DLW4: 4" DOTTED LINE @ 0.22														
LOCATION								LENGTH BY LINE TYPE (UNFACTORED)														
ROAD ID	STATION TO STATION			DIR. OF TRAVEL	MARKING TYPE	SIDE			BCY4 STA	DCY4 STA	NPY4 STA	BLW4 STA	ELW4 STA	ELY4 STA	SLW2 STA	DLW4 STA	REMARKS					
						L	C	R														
H54	221+86	224+69	NORTH	BROKEN CENTERLINE (YELLOW)		X		2.83									REGION 1V					
H54	224+69	227+39	NORTH	NO PASSING ZONE (YELLOW)			X			2.70							REGION 1V					
H54	227+39	230+12	NORTH	DOUBLE CENTERLINE (YELLOW)		X			2.73								REGION 1V					
H54	230+12	232+89	NORTH	NO PASSING ZONE (YELLOW)	X					2.77							REGION 1V					
H54	232+89	242+85	NORTH	BROKEN CENTERLINE (YELLOW)		X		9.96									REGION 1V					
H54	100+00	193+06	EAST	EDGE LINE (WHITE)			X					93.06					REGION 1V					
H54	193+54	215+49	NORTH	EDGE LINE (WHITE)			X					13.29					REGION 1V					
H54	207+31	219+09	NORTH	EDGE LINE (WHITE)			X					3.12					REGION 1V					
H54	210+91	222+74	NORTH	EDGE LINE (WHITE)			X					3.17					REGION 1V					
H54	214+56	226+53	NORTH	EDGE LINE (WHITE)			X					3.31					REGION 1V					
H54	218+35	230+27	NORTH	EDGE LINE (WHITE)			X					3.26					REGION 1V					
H54	222+09	239+94	NORTH	EDGE LINE (WHITE)			X					9.19					REGION 1V					
H54	231+76	246+52	NORTH	EDGE LINE (WHITE)			X					6.1					REGION 1V					
H54	238+34	251+51	NORTH	EDGE LINE (WHITE)			X					4.51					REGION 1V					
H54	100+00	126+86	EAST	EDGE LINE (WHITE)	X							26.86					REGION 1V					
H54	126+86	234+82	EAST	EDGE LINE (WHITE)	X							98.82					REGION 1V					
H54	234+82	251+51	NORTH	EDGE LINE (WHITE)	X							16.21					REGION 1V					
					REGION 1V SUBTOTALS			45.81	41.13	47.25	0.00	280.90	0.00	0.00	0.00							
					QUANTITY FACTORS			0.17	1.34	0.84	0.17	0.67	0.67	4.00	0.22							
					REGION 1V TOTALS			7.79	55.11	39.69	0.00	188.20	0.00	0.00	0.00		TOTAL 290.79 STATIONS					
GINKO AVE	96+45	105+95	NORTH	DOUBLE CENTERLINE (YELLOW)		X			9.50								REGION 1W					
GINKO AVE	105+95	107+59	NORTH	NO PASSING ZONE (YELLOW)			X			1.64							REGION 1W					
GINKO AVE	107+59	112+29	NORTH	NO PASSING ZONE (YELLOW)	X					4.70							REGION 1W					
GINKO AVE	112+29	114+46	NORTH	BROKEN CENTERLINE (YELLOW)		X		2.17									REGION 1W					
GINKO AVE	114+46	116+16	NORTH	NO PASSING ZONE (YELLOW)	X					1.70							REGION 1W					
GINKO AVE	116+16	121+26	NORTH	BROKEN CENTERLINE (YELLOW)		X		5.10									REGION 1W					
GINKO AVE	121+26	130+86	NORTH	NO PASSING ZONE (YELLOW)			X			9.60							REGION 1W					
GINKO AVE	130+86	135+25	NORTH	DOUBLE CENTERLINE (YELLOW)		X		4.39									REGION 1W					
GINKO AVE	135+25	144+60	NORTH	NO PASSING ZONE (YELLOW)	X					9.35							REGION 1W					
GINKO AVE	144+60	147+68	NORTH	BROKEN CENTERLINE (YELLOW)		X		3.08									REGION 1W					
GINKO AVE	147+68	159+59	NORTH	NO PASSING ZONE (YELLOW)			X			11.91							REGION 1W					
GINKO AVE	96+45	97+76	NORTH	EDGE LINE (WHITE)			X					1.31					REGION 1W					
GINKO AVE	98+24	102+76	NORTH	EDGE LINE (WHITE)			X					4.52					REGION 1W					
GINKO AVE	103+24	159+59	NORTH	EDGE LINE (WHITE)			X					56.35					REGION 1W					
GINKO AVE	96+45	97+76	NORTH	EDGE LINE (WHITE)	X							1.31					REGION 1W					
GINKO AVE	98+24	102+76	NORTH	EDGE LINE (WHITE)	X							4.52					REGION 1W					
GINKO AVE	103+24	106+66	NORTH	EDGE LINE (WHITE)	X							3.42					REGION 1W					
GINKO AVE	107+14	110+66	NORTH	EDGE LINE (WHITE)	X							3.52					REGION 1W					
GINKO AVE	111+14	159+59	NORTH	EDGE LINE (WHITE)	X							48.45					REGION 1W					
					REGION 1W SUBTOTALS			10.35	13.89	38.90	0.00	123.40	0.00	0.00	0.00							
					QUANTITY FACTORS			0.17	1.34	0.84	0.17	0.67	0.67	4.00	0.22							
					REGION 1W TOTALS			1.76	18.61	32.68	0.00	82.68	0.00	0.00	0.00		TOTAL 135.73 STATIONS					