

INDEX OF SHEETS	
No.	DESCRIPTION
A Sheets	Title Sheets
A.1	Title Sheet
A.2	Location Map Sheet
C Sheets	Quantities and General Information
C.1	Estimated Project Quantities & Reference Information
C.2	General Notes
C.3	Standard Road Plans
C.4	Tabulation
J Sheets	Traffic Control and Staging Sheets
J.1	Traffic Control Plan
J.2	511 Travel Restrictions
J.3	Coordinated Operations
J.4	Allowable Lane Closure Map



PLANS OF PROPOSED IMPROVEMENT ON THE
INTERSTATE ROAD SYSTEM
FRANKLIN COUNTY
PCC PATCHING
Co Rd C47 (Dows) to Minnesota State Line

SCALES: As Noted

Refer to the Proposal Form for list of applicable specifications.

Value Engineering Saves. Refer to Article 1105.14 of the Specifications.



SEE SHEET A.2
FOR LOCATION DETAILS

Franklin County BI-DIRECTIONAL				
From Co Rd C25 to Co Rd C13				
DESIGN DATA RURAL				
20 24	AADT	16900	V.P.D.	
20 -	AADT	--	V.P.D.	
20 -	DHV	--	V.P.H.	
TRUCKS		29.4	%	
Total				
Design ESALs		--		

Cerro Gordo County BI-DIRECTIONAL				
Co Rd B20 to Worth County				
DESIGN DATA RURAL				
20 24	AADT	21100	V.P.D.	
20 -	AADT	--	V.P.D.	
20 -	DHV	--	V.P.H.	
TRUCKS		31.02	%	
Total				
Design ESALs		--		

Worth County BI-DIRECTIONAL				
Co Rd 105 to MN				
DESIGN DATA RURAL				
20 24	AADT	19300	V.P.D.	
20 -	AADT	--	V.P.D.	
20 -	DHV	--	V.P.H.	
TRUCKS		31.71	%	
Total				
Design ESALs		--		

I hereby certify that this engineering document was prepared by me or under my direct personal supervision and that I am a duly licensed Professional Engineer under the laws of the State of Iowa.

04/03/2026

Signature _____ Date _____

Printed or Typed Name DUSTEN D. ROLANDO

My license renewal date is December 31, 2027

Pages or sheets covered by this seal: A.1-A.2, C.1-C.4, J.1-J.4

REVISIONS

TOTAL
10

PROJECT IDENTIFICATION NUMBER

26-35-035-010

PROJECT NUMBER

MPIN-035-2(733)160--0N-35

R.O.W. PROJECT NUMBER

M.P. 159.20
BEGIN PROJECT

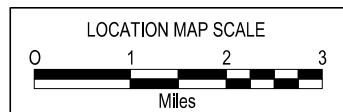
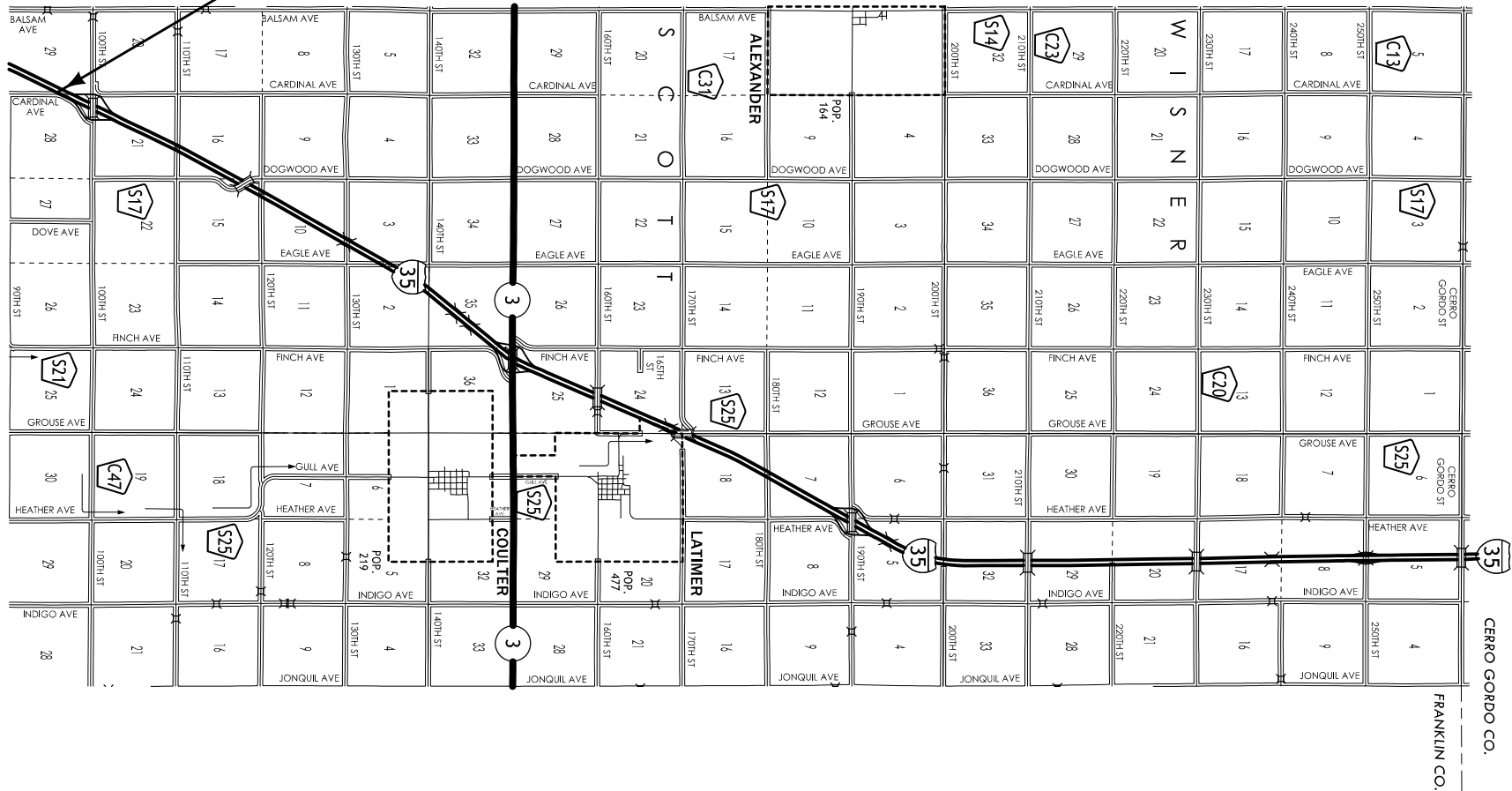

M.P. 218.52
END PROJECT

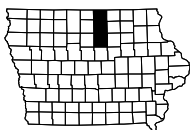
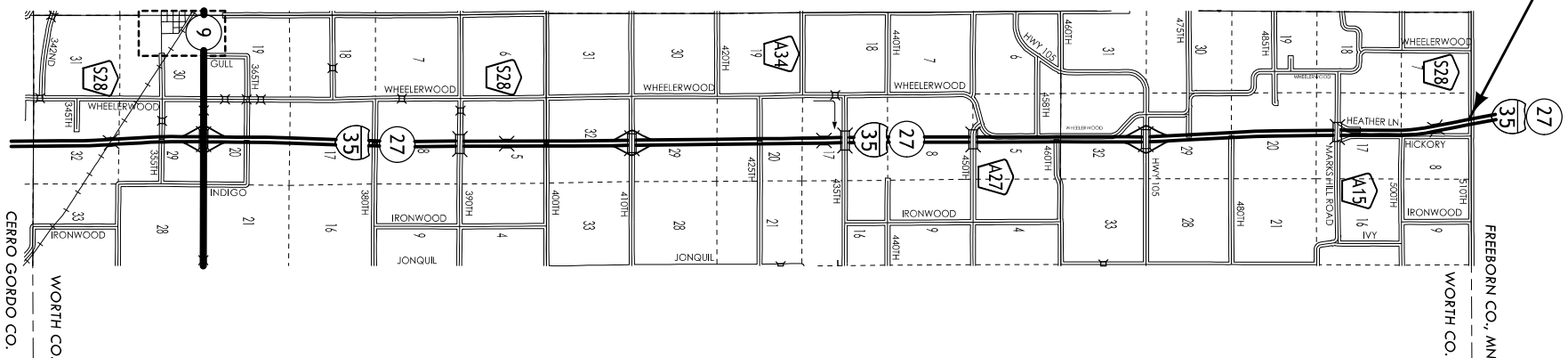
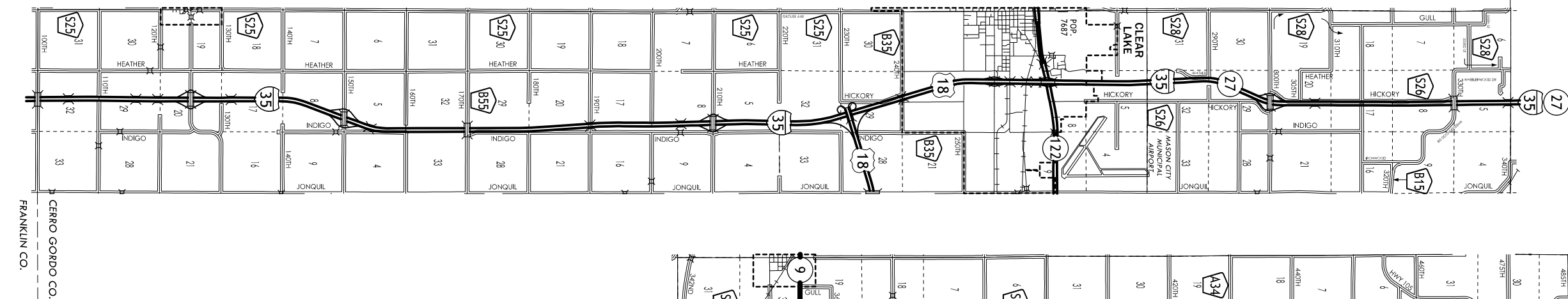

ESTIMATED PROJECT QUANTITIES AND REFERENCE NOTES

Roadway Items : Roadway Items

Item no.	Item Code	Item	Unit	Quantities	Estimate Reference Notes
				Estimated	
				Roadway Items	
1	2528-8445110	TRAFFIC CONTROL	LS	1	Refer to Tabulation 108-23A and J-Sheets for additional information.
2	2529-5070110	PATCHES, FULL-DEPTH FINISH, BY AREA	SY	485.94	Refer to Tabulation 102-06C for additional information. An additional 30% quantity is added to this item for discretionary placement as directed by the engineer.
3	2529-5070120	PATCHES, FULL-DEPTH FINISH, BY COUNT	EACH	34	
4	2529-8174020	SUBBASE PATCH WITH EF JOINT	SY	40	Refer to Tabulation 102-06C for additional information.
5	2529-8174050	PATCH SUBDRAIN	EACH	2	
6	2529-8201000	JOINT ASSEMBLY, EF	EACH	2	
7	2533-4980005	MOBILIZATION	LS	1	--

253_01
9/28/22

MEDIAN CROSSOVER

The Contractor is prohibited from using any established or other type median crossover on this project unless specifically designated for the Contractor's use by this plan.

262_06
9/28/22

UTILITIES (NOT A POINT 25 PROJECT)

This is NOT a POINT 25 project and is not subject to the provisions of IAC 761-115.25.

<div>105_04 4/21/26</div> <div>STANDARDS</div> <div>The following Standards apply to construction work on this project.</div>		
Number	Date	Title
PR-101	10-21-25	Full Depth Patch with 'EF' Joint in PCC
PR-103	10-21-25	Full Depth PCC Patch with Dowels
PR-104	04-21-26	Full Depth Patch continuous Reinforced PCC Pavement
PR-140	04-21-15	Subbase Patches
PV-101	10-21-25	Joints
TC-1	10-15-19	Work Not Affecting Traffic (Two-Lane or Multi-Lane)
TC-402	04-18-23	Work Within 15 ft of Traveled Way
TC-418	04-18-23	Lane Closure on Divided Highway
TC-420	10-16-18	Lane Closure at Ramps

102_06C 4/21/26																					
FULL-DEPTH PATCHES																					
Line No.	Count	Station	Reference Location Sign	Direction of Travel	Side	Length (FT)	Width (FT)	Patch Thickness (IN)	Patch Repair or Finish	PCC Patch Type	PCC Patch Quantity (SY)	HMA Patches (SY)	Composite HMA (TON)	Subbase Patches (PR-140) (SY)	Subbase Patch with 'EF' Joint (PR-101) (SY)	Patch Subdrain PR-101 or PR-140 (No.)	'CD' Joints (No.)	'CT' Joints (No.)	'EF' Joints PR-101 (No.)	Anchor Lugs Removal (No.)	Remarks
1.0	1		163.3	NB	Right	12.0	12.0	16.0	Finish	PCC C R C (PR-104)	16.0										
2.0	1		163.3	NB	Left	16.0	12.0	16.0	Finish	PCC C R C (PR-104)	21.3										
3.0	1		163.32	NB	Right	15.0	12.0	16.0	Finish	PCC C R C (PR-104)	20.0				20.0	1			1		
4.0	1		163.32	NB	Left	15.0	12.0	16.0	Finish	PCC C R C (PR-104)	20.0				20.0	1			1		
5.0	1		163.35	NB	Right	8.0	12.0	16.0	Finish	PCC C R C (PR-104)	10.7										
6.0	1		163.35	NB	Left	8.0	12.0	16.0	Finish	PCC C R C (PR-104)	10.7										
7.0	1		163.38	NB	Right	20.0	12.0	16.0	Finish	PCC C R C (PR-104)	26.7										
8.0	1		165.16	NB	Right	8.0	12.0	16.0	Finish	PCC C R C (PR-104)	10.7										
9.0	1		186.63	NB	Right	8.0	12.0	12.0	Finish	PCC C R C (PR-104)	10.7										
10.0	1		186.63	NB	Left	8.0	12.0	12.0	Finish	PCC C R C (PR-104)	10.7										
11.0	1		187.88	NB	Right	10.0	12.0	12.0	Finish	PCC C R C (PR-104)	13.3										
12.0	1		187.88	NB	Left	10.0	12.0	12.0	Finish	PCC C R C (PR-104)	13.3										
13.0	1		191.64	NB	Left	8.0	12.0	12.0	Finish	PCC C R C (PR-104)	10.7										
14.0	1		191.78	NB	Left	8.0	12.0	12.0	Finish	PCC C R C (PR-104)	10.7										
15.0	1		204.53	NB	Right	12.0	12.0	21.5	Finish	PCC C R C (PR-104)	16.0										
16.0	1		211.51	NB	Right	8.0	12.0	21.5	Finish	PCC C R C (PR-104)	10.7										
17.0	1		211.51	NB	Left	8.0	12.0	21.5	Finish	PCC C R C (PR-104)	10.7										
18.0	1		204.55	SB	Right	8.0	12.0	21.5	Finish	PCC C R C (PR-104)	10.7										
19.0	1		201.69	SB	Right	8.0	12.0	23.0	Finish	PCC C R C (PR-104)	10.7										
20.0	1		191.93	SB	Right	8.0	12.0	12.0	Finish	PCC C R C (PR-104)	10.7										
21.0	1		191.63	SB	Left	8.0	12.0	12.0	Finish	PCC C R C (PR-104)	10.7										
22.0	1		186.64	SB	Left	10.0	12.0	12.0	Finish	PCC C R C (PR-104)	13.3										
23.0	1		181.83	SB	Left	8.0	12.0	16.0	Finish	PCC C R C (PR-104)	10.7										
24.0	1		163.41	SB	Right	8.0	12.0	16.0	Finish	PCC C R C (PR-104)	10.7										
25.0	1		163.32	SB	Right	20.0	12.0	16.0	Finish	PCC C R C (PR-104)	26.7										
26.0	1		163.32	SB	Left	20.0	12.0	16.0	Finish	PCC C R C (PR-104)	26.7										
Total:		26									373.8				40	2			2		

108_23A
8/15/22

TRAFFIC CONTROL PLAN

Through traffic shall be maintained at all times.

511 TRAVEL RESTRICTIONS										108_25 3/28/24
Line No.	Route	Direction	County	Location Description	Feature Crossed	Object Type	Maint. Bridge No. or Structure ID or FHWA No.	Type of Restriction	Existing Measurement	Remarks
1.0	I-35	Both	Franklin					None		No travel restrictions anticipated
2.0	I-35	Both	Cerro Gordo					None		
3.0	I-35	Both	Worth					None		

<div>111_01 10/14/22</div> <div>COORDINATED OPERATIONS</div> <div>Other work in progress during the same period of time will include the construction of the projects listed. Coordinate operations with those of other contractors working within the same area.</div>	
Project	Type of Work
IMX-035-6(143)172--02-35	PCC Grade/Replace
IMN-035-8(055)205--0E-98	Microsurfacing
IMX-035-8(054)211--02-98	HMA Resurfacing w/ Milling
IMX-035-8(056)209--02-98	Bridge Deck Overlay
	Others to be discussed at Pre-Con

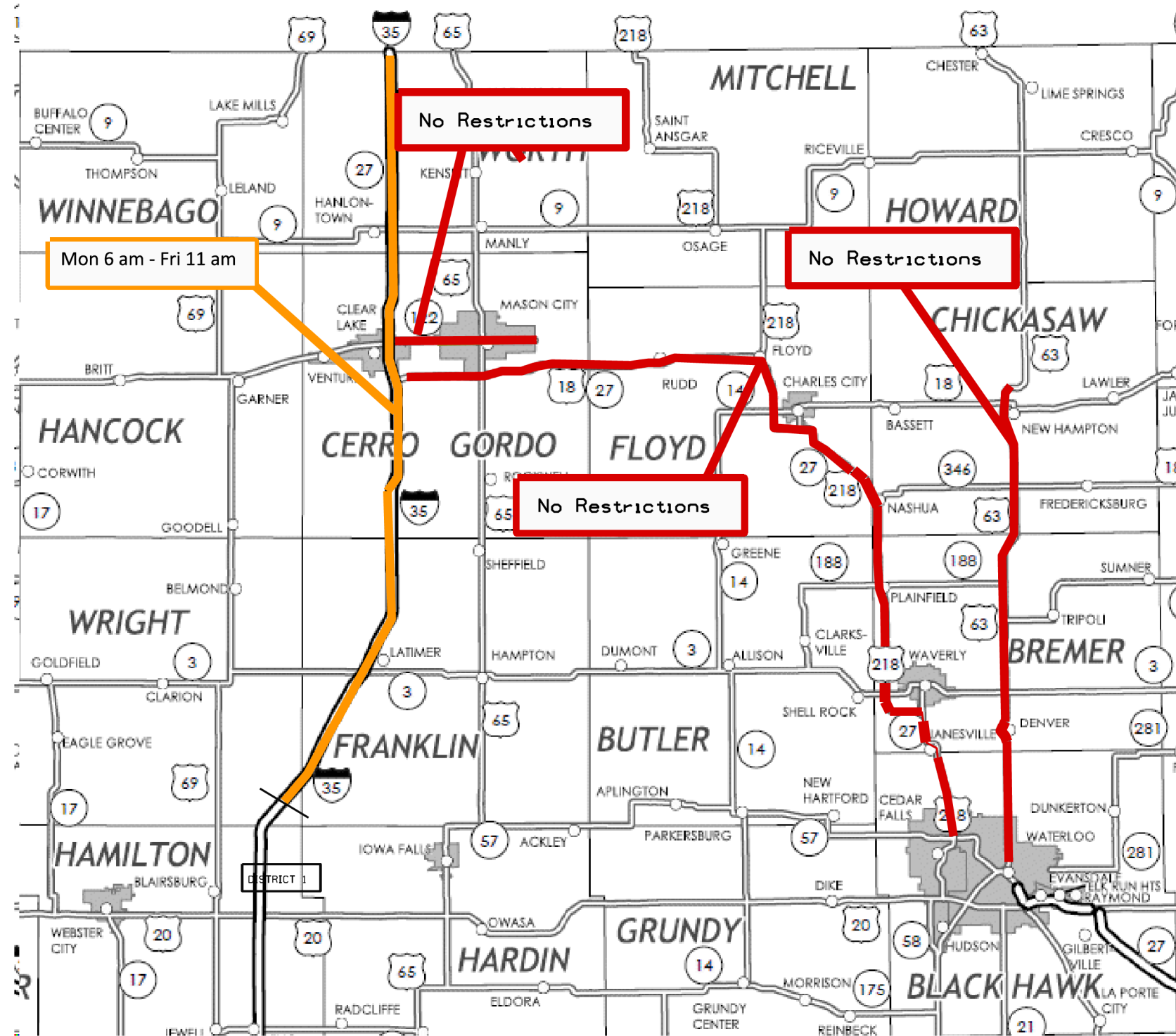

CONSTRUCTION and MAINTENANCE
ALLOWABLE MULTI - LANE
LANE CLOSURE MAP
DISTRICT 2