

OUTSIDE EDGELINE OR LANELINE - DIVIDED OR UNDIVIDED

Possible Contract Item:
Traffic Control

Equip all vehicles with an amber revolving light or amber strobe light.

- ① Optional Fluorescent Yellow Green (FYG) sign background may be used.
- ② This arrow board may be operated in a four-corner caution mode.
- ③ A vehicle mounted Portable Dynamic Message Sign (PDMS) may be used in lieu of this sign.
- ④ Refer to SI-881 for sign details.
- ⑤ TMA required for speed limits of 55 mph or greater.

LEGEND

Direction of Traffic

Truck-Mounted Attenuator (TMA)

STANDARD ROAD PLAN

REVISIONS: Added Circle Note 5.

APPROVED BY DESIGN METHODS ENGINEER

PAVEMENT MARKING OPERATIONS

REVISION	
7	10-17-17
TC-433	
SHEET 1 of 3	

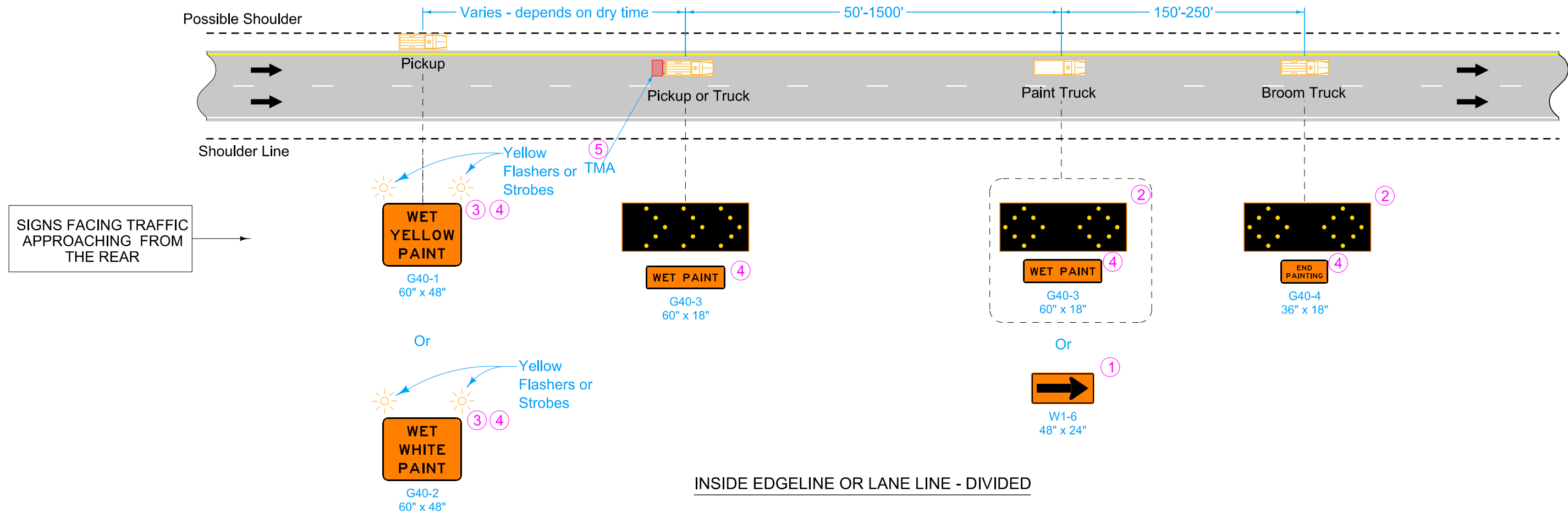

LEGEND

← Direction of Traffic

Truck-Mounted Attenuator (TMA)

- ① Optional Fluorescent Yellow Green (FYG) sign background may be used.
- ② This arrow board may be operated in a four-corner caution mode.
- ③ A vehicle mounted Portable Dynamic Message Sign (PDMS) may be used in lieu of this sign.
- ④ Refer to SI-881 for sign details.
- ⑤ TMA required for speed limits of 55 mph or greater.

IOWA DOT	REVISION	
	7	10-17-17
STANDARD ROAD PLAN	TC-433	
REVISIONS: Added Circle Note 5.	SHEET 2 of 3	
APPROVED BY DESIGN METHODS ENGINEER		
PAVEMENT MARKING OPERATIONS		

SIGNS FACING
OPPOSING TRAFFIC

END
PAINTING
G40-4
36" x 18"

W1-6
48" x 24"

WET PAINT
G40-3
60" x 18"

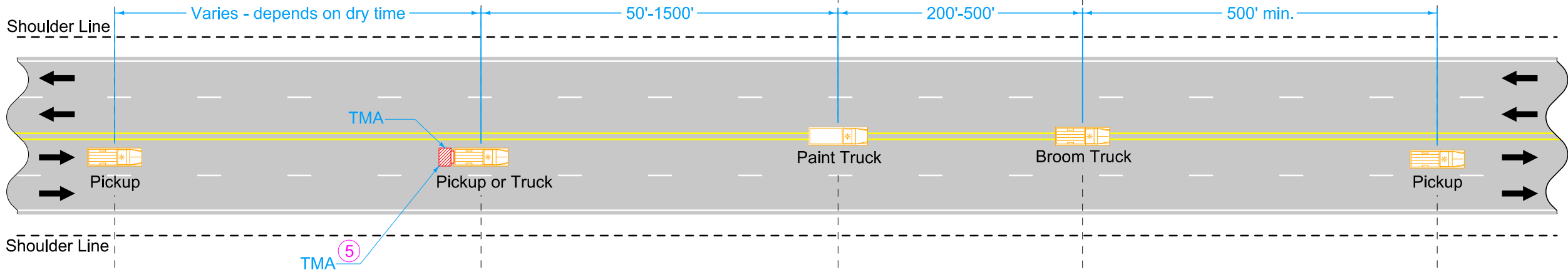
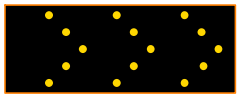
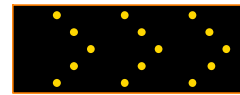

SIGNS FACING TRAFFIC
APPROACHING FROM
THE REAR

WET PAINT
G40-3
60" x 18"

WET PAINT
G40-3
60" x 18"

WET PAINT
G40-3
60" x 18"

W1-6
48" x 24"

END
PAINTING
G40-4
36" x 18"

CENTERLINE - UNDIVIDED ONLY

LEGEND

- Direction of Traffic
- Truck-Mounted Attenuator (TMA)

- Optional Fluorescent Yellow Green (FYG) sign background may be used.
- This arrow board may be operated in a four-corner caution mode.
- Refer to SI-881 for sign details.
- TMA required for speed limits of 55 mph or greater.

IOWA DOT	REVISION	
	7	10-17-17
STANDARD ROAD PLAN	TC-433	
REVISIONS: Added Circle Note 5.	SHEET 3 of 3	
APPROVED BY DESIGN METHODS ENGINEER		
PAVEMENT MARKING OPERATIONS		